

INSTRUCTIONS CONTROL UNIT *MINI LG 150 / LG 250 A*

Your PICHLER comfort ventilation unit comes with a **MINI LG 150 / LG 250 A remote controller**. These brief instructions focus on the most important functions of your **MINI LG 150 / LG 250 A remote controller**, a square switching unit flush-mounted in the living area. Continuous operation of your comfort ventilation unit is necessary for proper functionality.

Key assignment MINI LG 150 / LG 250 A

Operation is via **4 push-buttons**.

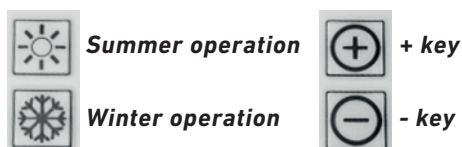

7 LEDs furthermore indicate the current status of the ventilation unit, filter check signals and any error signals.

- 1 Summer operation**
- 2 Winter operation**
- 3 Ventilation level 1 (absence mode)**
- 4 Ventilation level 2 (normal ventilation)**
- 5 Ventilation Level 3 (boost ventilation)**
- 6 Filter check signal**
- 7 Malfunction**

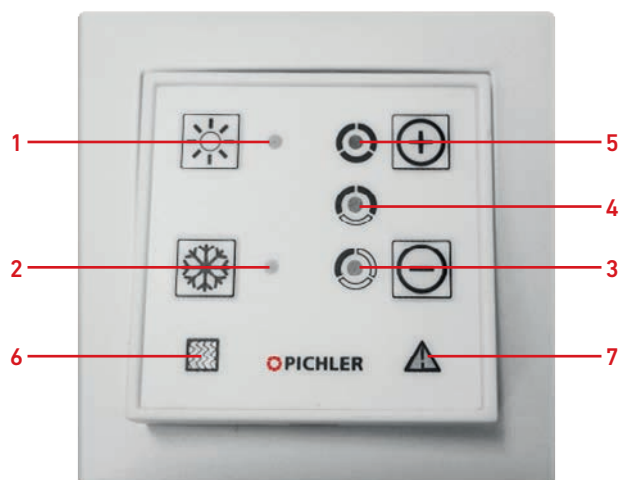

Operating the MINI LG 150 / LG 250 A



Switching on

Press the **+ key** until the LED in the fan symbol lights up green.



+ and - keys

+ and - keys = **for selecting ventilation levels:**

- Standby/Basic ventilation
- LS1 (Bottom LED)
- LS2 (Middle LED)
- LS3 (Top LED)

+ key = increase ventilation level

- key = decrease ventilation level

Depending on the system configuration, the system can be switched to "Standby" or "Basic ventilation" (bottom LED blinking).



Operating mode

Use the left symbol keys to switch between **summer and winter operation**.

Summer operation & top LED is green. Actively supplies living areas with cool summer air (the integrated bypass is active; heat recovery bypass as required).

Winter operation & bottom LED is green. Heats up fresh outdoor air via heat recovery, also using automatic re-heating batteries, if installed (the integrated bypass is deactivated).



Malfunction

The light-emitting diode in the warning triangle blinks red in different patterns. **Contact your installer!**

More detailed information about the blinking patterns can be found in the operating instructions.



Filters check

Filter check signal every 4 months. LED permanently yellow. Check filter for dirt and replace if necessary.

To delete the message after cleaning/replacing the filter, press the + and - key simultaneously for at least 5 seconds.

If the filter control light blinks six times in succession followed by a longer break, level 1 of the system monitoring is active. Details regarding the description of the system monitoring can be looked up in the operating instructions.



Premature filter exchange

Reset the filter timer without a filter message.

Press the + and - keys simultaneously for at least 5 seconds.



Switching off in standby mode

Switching off (standby mode) – only when performing work generating a lot of dust. Only possible if “Basic ventilation” is deactivated.

When reaching ventilation level 1, press the – **key** again until no LED is lit.

When dust generating work is complete, press the **+ key** to switch the unit on again.

NOTE: These brief instructions do NOT substitute the **Operating Manual** which is available for download on the Internet. We furthermore recommend concluding a **contract for annual servicing** by a specialised and officially licensed company.

ATTENTION: Only authorised specialist staff may perform work on the ventilation unit (except filter replacement)!